



2/10 Bobbin Head Road Pymble NSW

4  3  2 

OPEN FOR INSPECTION

Wednesday 2 pm - 2:30 pm

Saturday 3:30 pm - 4 pm

Sunday 10:00 am - 10:30 am

Presenting a rare opportunity to secure a luxurious townhouse in the heart of Pymble, this refined residence in an exclusive boutique complex blends modern elegance with functional design.

Spanning three levels, this 4-bedroom, 3.5-bathroom home suits families, professionals, or downsizers seeking a premium, low-maintenance lifestyle without compromise.

At its heart, expansive open-plan living and dining areas

[For full version visit the website](https://www.plusagency.com.au)

Type : Townhouse

Price : Contact Agent

View : <https://www.plusagency.com.au/sale/nsw/north-s-hore-upper/pymble/residential/townhouse/8324452>

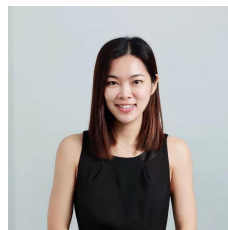

Stephenie Wong
0411 820 677



Selin/Jiaqian Wei
0406 580 388

HOUSE

2/10 Bobbin Head Road,
Pymble

AREA

Total Area: 235m²
Parking Area: 30m²

 4
  3.5
  2



Disclaimer: This plan is presented in good faith and is to be used as a guide. It does not constitute an offer or contract. All area sizes indicated are approximate only. Positions of furniture fittings and the like are not indicative of final positioning.

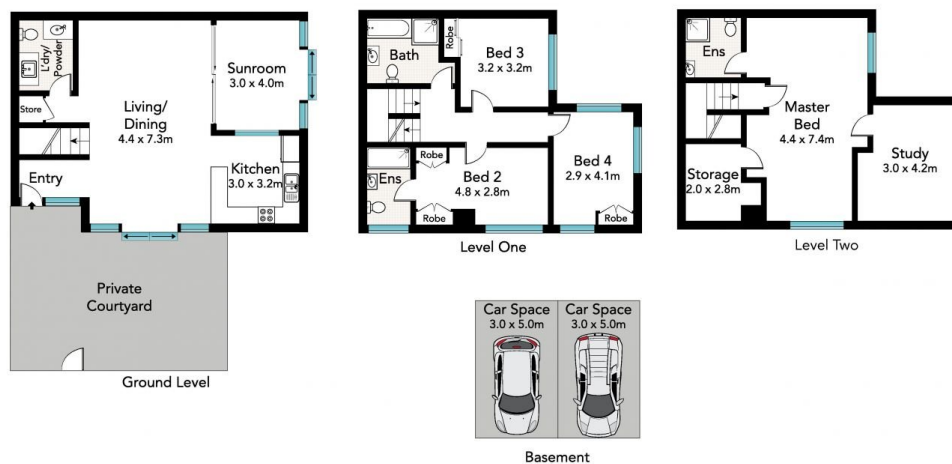

Ground Level

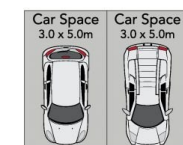

Basement